



Nether Court | | Farnsfield | NG22 8JU

£550,000



Jonathan Fitzpatrick
VILLAGE & COUNTRY HOMES

Nether Court |
Farnsfield | NG22 8JU
£550,000

Make immediate arrangements to view this exceedingly spacious, extended 4 bedroom, 4/5 reception room detached family home located in the much favoured Brickyard Lane area of Farnsfield. This attractive, modern family home boasts a superb south rear garden and is just a few minutes walk to the picturesque Southwell Trail nature reserve. Offered for sale in excellent decorative order throughout, this highly specified home includes an attractive Shaker style re-fitted kitchen, separate dining room, family room, snug, large lounge and study area to the rear. There is also a newly fitted luxury downstairs shower room/cloakroom, plus re-fitted first floor family bathroom. The accommodation is complimented by a single garage and ample driveway parking to the front. Nether Court is a quiet cut de sac and provides convenient access to village shops, restaurants, pubs, primary school and many other amenities. Please call us for more details and viewing arrangements.

- Spacious 4 bedroom (extended) detached house in favoured location close to Southwell Trail
- Re-fitted Shaker style luxury kitchen breakfast room
- Large south facing rear garden
- Excellent decorative order throughout
- Close to all village amenities including primary school. Catchment area for Minster secondary school in Southwell
- Lounge, study, family room, snug and dining room
- Newly fitted downstairs shower room and cloakroom w/c
- Garage and generous off road parking
- Quiet, cul de sac location

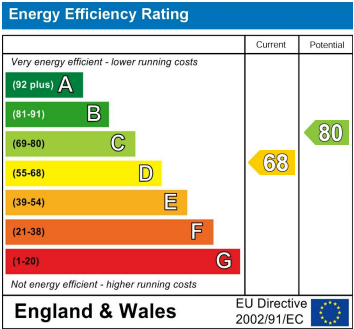
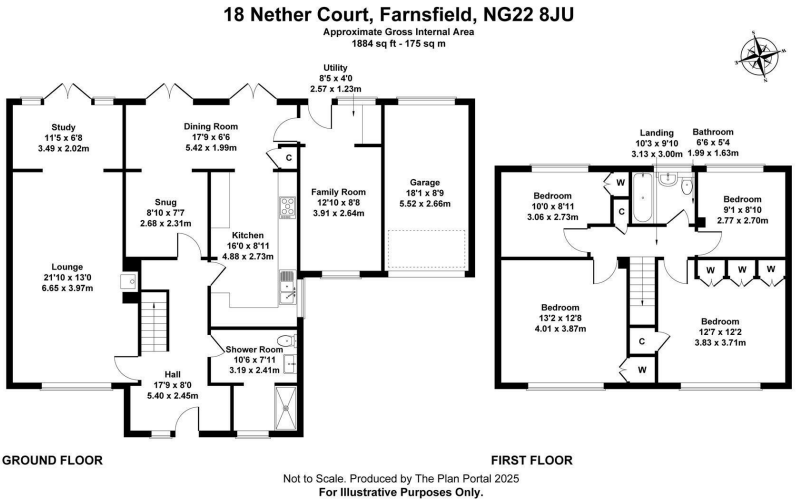

64 Main Street
Farnsfield
Nottinghamshire
NG22 8EF
01623 392676
mail@jfea.co.uk
www.jfea.co.uk